

CONNECTIVITY

Built-in PoE/PoE+ and WiFi communication backbone leverages existing and common infrastructure and reduces installation costs. Add, move and configure doors in minutes, even from remote locations.

REAL-TIME (5-10 sec.)

On-demand wake-ups for Lockdowns and Open Door commands...also events and notifications from LoxIQ™ to the AxessIQ™ software.

NETWORK-ON-CARD

Our credentials go beyond just passing a number to the reader. They know where they belong and perform a handshake with the readers for ultimate security. They also pick up lock transactions and download door updates to offline LoxIQ™ locksets.

EXPANSION

Unlimited BoxIQ™ controllers, doors and sites. Unlimited users and credentials.

ENCRYPTION

Upstream and downstream communications utilize AES 256-bit encryption.

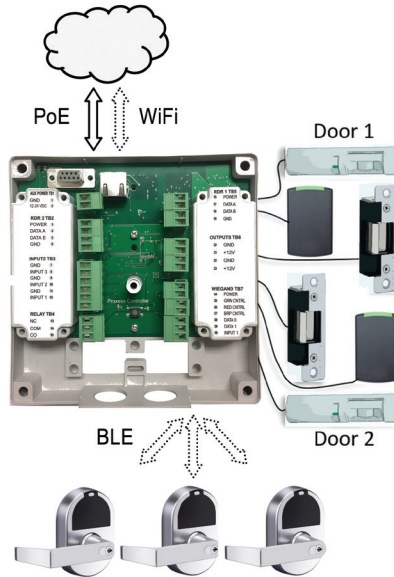

The BoxIQ™ door controller connects either two doors with one reader each or a single door with both entry and exit readers to the AxessIQ™ software. The BoxIQ™ can also bring your LoxIQ™ compatible electronic locksets online.

For communication reliability and optimal battery performance, up to seven (7) LoxIQ™ locksets may be connected to a BoxIQ™ via Bluetooth Low Energy (BLE) and LoxIQ™ locksets are assigned in the AxessIQ™ software to a specific BoxIQ™ or BlueIQ™ controller.

LoxIQ™ units may typically be located at distances of up to a 70-foot radius from the gateway with reductions due to interference by walls, ceilings, floors and an abundance of other metal surfaces or equipment.

Our Network-on-Card credentials downloads transactions and uploads rights for the offline LoxIQ™ locksets which encourages the installation of fewer traditional, expensive, hardwired doors.

An unlimited number of BoxIQ™ controllers may be added to any site or AxessIQ™ system. Controllers are simply and quickly added to the system plugging directly into the facility's existing PoE or PoE+ infrastructure and defined in the AxessIQ™ software via static or DHCP addressing.

For those difficult to reach areas (eg, gates, out-buildings), the BoxIQ™ controller also includes a WiFi communications backbone where it would draw low voltage power from near the panel.

Providing security flexibility, BoxIQ™ provides on-demand lockdown and open-door commands and also receives emergency LoxIQ™ events.

FEATURES

- Two access control doors with one reader each or one door with entry & exit readers
- Brings your LoxIQ™ locksets "online" (typically 5-10 seconds for downstream commands) via BLE (Bluetooth Low Energy)
- Connect a PoE/PoE+ network cable, or power with a transformer and use your existing WiFi
- Allows centralized Lockdown and Open Door commands to LoxIQ™ locksets
- Highest level security cards, using Mifare DESFire EV2™ and BLE
- Credentials collect transactions from and download updates to LoxIQ™ locksets. Security handshakes for verification.
- Future RS-485 communication with LoxIQ™ and downstream sub-controllers

System Specifications

PROXESS
BoxIQ™

MODEL NUMBERS

BX-XFI
BX-NFI

COMPATIBILITY

Proxess RoxIQ™ bi-directional, read-write readers, via RS-485; Proxess LoxIQ™ series electronic locksets, via BLE.

ONE or TWO DOORS

Standard configuration for two doors, with a single reader for each. A software checkbox reconfigures for one door, with an entry and an exit reader.

SIMPLE ANTI-PASSBACK

Simplified anti-passback alternative. One checkbox forces cardholders to use a chokepoint reader for their credential reauthorization, programmable from one day to many years.

GATEWAY ANTENNA

Built-in BLE antenna to provide “on-demand” communications to up to seven LoxIQ™ locksets.

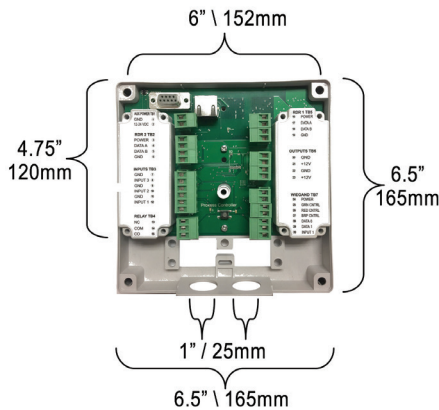

SYSTEM SPECIFICATIONS

Cardholders	Unlimited
Controllers per System	Unlimited
Stored Events	50,000
Time Zones	Unlimited
Access Levels	Unlimited
Data Retention	30 Days, NOVRAM
Reader Communication	RS-485, Bi-Directional
Door Open Time	0-99,999 seconds
Operating System	Linux, SOM On-board

ELECTRICAL

PoE\PoE+ Voltage Input	Power Output (PoE+ AT Type 2)
Line Voltage Input	11-14VDC at 900mA max
Current Consumption	200mA
Lock 1 Relay Voltage	12\24VDC
Lock 1 Relay Current	3A
Lock 2 Output Voltage	12VDC
Lock 2 Output Current	3A
Alarm Output Current	1A
Power Output (AF-AT Type 1)	10.3W
Power Output (PoE+ AT Type 2)	20.4W

FEATURES

Reader Ports	2
Input for Request-to-Exit	2
Input for Door Contact	1
Alarm Output	2
Auxiliary Inputs	2
In\Out Reader Configuration	Yes
Enclosure Tamper Input	Yes
Enclosure Knock-Outs	Yes, 2 x 1 inch

HARDWARE

Network Cable Type	CAT-5\6, 2C, 22AWG, OS
Reader Cable Type	4C, 22AWG, OS
REX Cable Type	4C, 22AWG, OS
Door Contact Cable Type	2C, 22AWG, OS
Lock Release Cable Type	2C, 18AWG
RS-485 Cable Output Type	4C, 22AWG, OS

COMMUNICATIONS

TCP/IP (Wired)	Yes, 100Mbps
WiFi, 8.02.11 (Wireless)	Yes
Bluetooth Low Energy (BLE)	Yes
RS-485	Yes, 115Kbps
Ethernet Bandwidth	200 kbps
DHCP	Yes, Default
Static IP Support	Yes

ENVIRONMENT

Operating Temperature	-20°C - +55°C -20°F - +132°F
Moisture Resistance	No – Provide Suitable Enclosure to Environment

